

# MOTOMAN MH3BM

Food & Pharma Applications  
with the MH-series

## Handling & Biomedical Applications

The MOTOMAN MH3BM is a high speed robot model to cover handling applications in the pharmaceutical, chemical and medical industry and for other applications under harsh environmental conditions. High payload capability (3 kg), best motion speed and working range (allowing one full turn of the main S-axis) are unique and best in class. Power cables are guided through the baseplate through the robot's base socket, application cables can be guided through the robot arm, both keeping your installation tidy and easy to clean.

The special coating and surface enables cleaning with hydrogen peroxide. The enclosed structure is sealed to provide ingress protection conforming to IP67 for the wrist and IP65 for the main axes. It complies with ISO cleanroom class 5, which does not allow dust to be generated or adhere.

This robot is driven by the compact FS100 controller.

### KEY BENEFITS

- Compact and lightweight
- Highest payload (3 kg) and motion range in its class
- Washdown design for excellent hygiene management: ISO class 5 (DIN ISO 14644-1), clean room rated
- Base with power cable exit, provides sealed environment



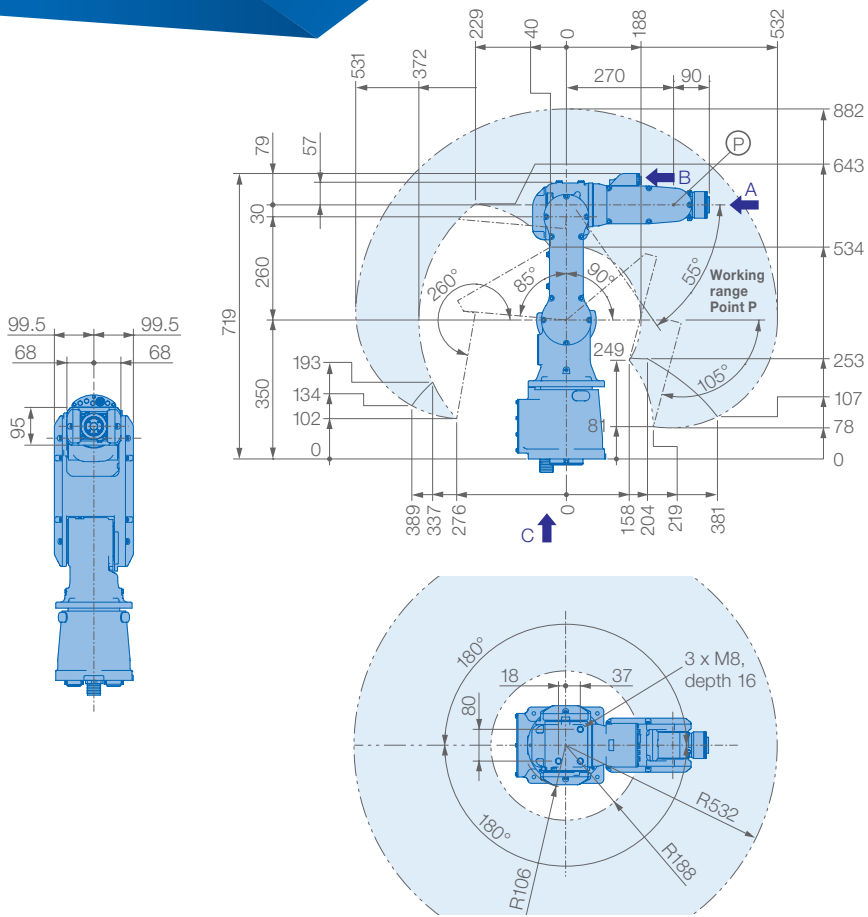

View A

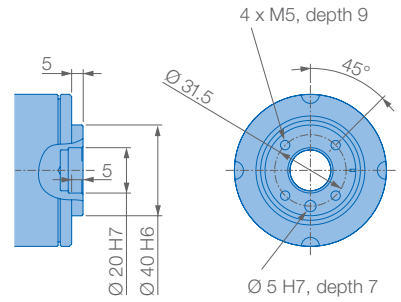

View B

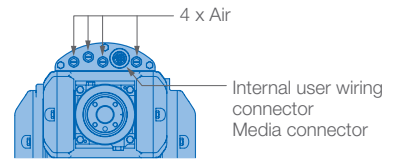

View C

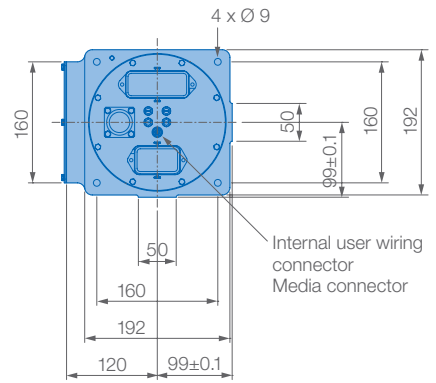

Mounting options: Floor, ceiling, wall  
Protection class: IP65/67

Allowable wrist load

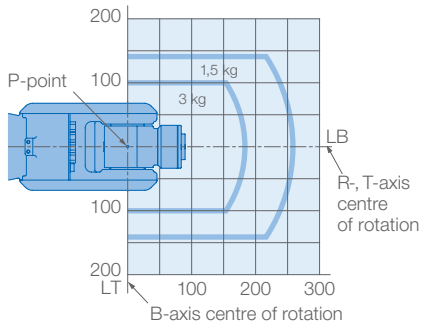

Specifications MH3BM						
Axes	Maximum motion range [°]	Maximum speed [°/sec.]	Allowable moment [Nm]	Allowable moment of inertia [kg · m <sup>2</sup> ]	Controlled axes	6
S	±180	310	-	-	Max. payload [kg]	3
L	+90/-85	150	-	-	Repeatability [mm]	±0.03
U	+260/-105	190	-	-	Max. working range R [mm]	532
R	±170	300	5.39	0.10	Temperature [°C]	0 to +40
B	±120	300	5.39	0.10	Humidity [%]	20 - 80
T	±360	420	2.94	0.03	Weight [kg]	27
					Power supply, average [KVA]	0.5